



INSTRUCTIONS

FIXING PLATES: STRAIGHT SECTIONS



FIXING PLATES STRAIGHT SECTION

Designed for added security and stability, these fixing plates allow you to easily anchor QUICKBLOCK structures to the ground.

- Straight sections of the fixing plates come in 1.8M (4 block) lengths.
- These lengths can be cut to size for a shorter section.
- All lengths are pre-drilled with the correct holes to ensure a perfect fit with QUICKBLOCK.

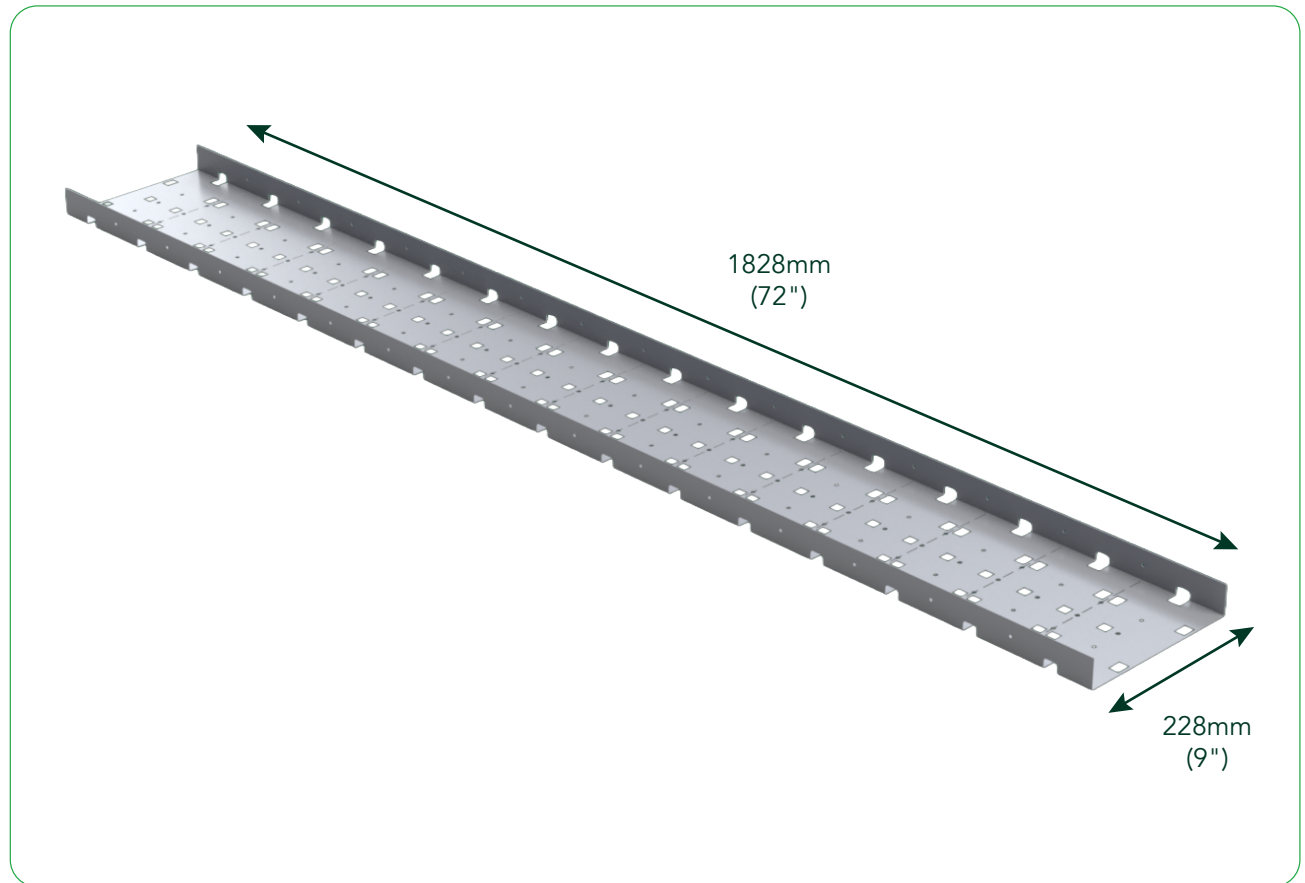

STRUCTURE FIXING MATRIX

When should you use QUICKBLOCK Fixing Plates? Refer to the matrix below for guidance. It outlines situations where Fixing Plates are required, where they may be beneficial, and where they are not necessary.

	Structure is required to be mechanically fixed to the ground.	Structure requires extra weight but does not need to be mechanically fixed to the ground.	Structure cannot be filled but requires extra strength and stability.	Structure requires tensioned walls.	Structure is temporary and non-load bearing.	Structure is semi-permanent and is load bearing.
FIXING PLATES						
LOOSE INFILL (SOIL, SAND OR AGGREGATE)						
RUBBER BLOCKS						
LEAVE BLOCKS EMPTY						



APPLICABLE



SOMEWHAT APPLICABLE
Please contact our design team to find out more info.



NOT APPLICABLE





Skip these steps if you are not bolting the fixing plates to the ground.

STEP 1

Use an M6 drill bit and appropriate drill to drill pilot holes into the ground.

STEP 2

Use locating holes at regular intervals to ensure a strong connection to the ground.

STEP 3

Ensure you secure the Fixing Plates twice per length, as shown in step 8 and 9.

①

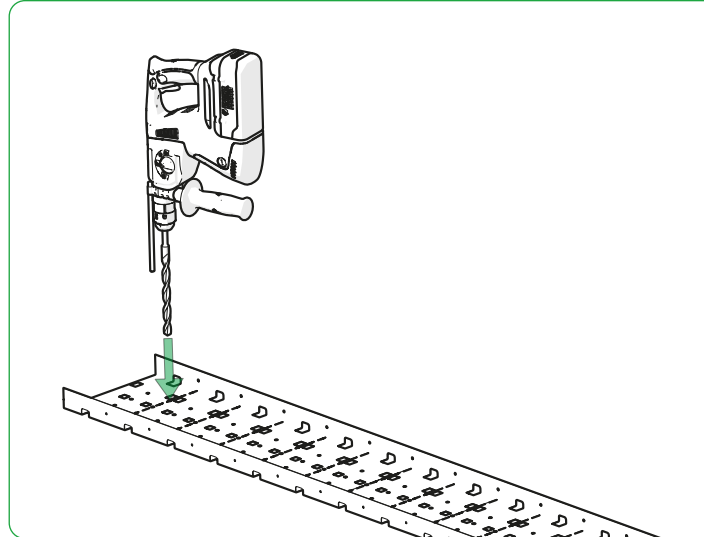

②

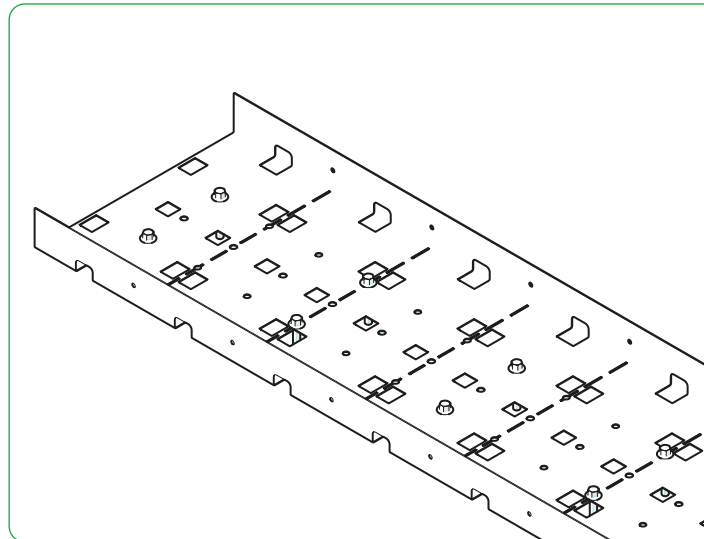
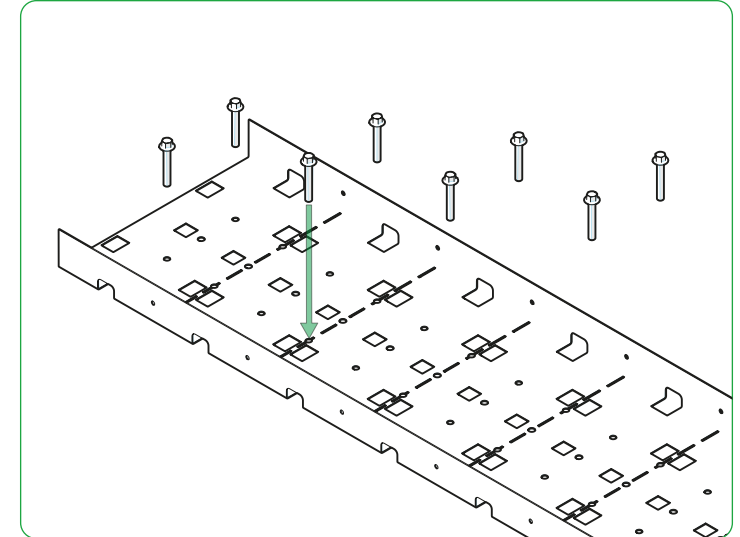

③

ONLY BOLT DOWN FIXING PLATES IF:

- The QUICKBLOCK structure being built is semi-permanent or permanent.
- There is appropriate ground to fix to, soft ground will not work.
- You require the structure to be as strong as possible.



STEP 4

Slide the Ground Clip into the shown Fixing Plate hole.

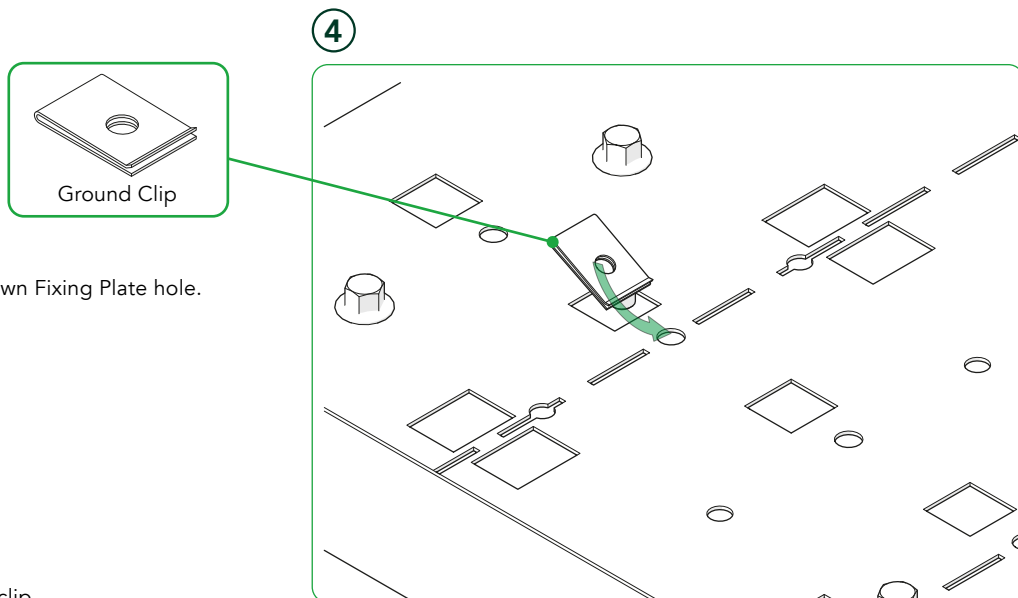
**STEP 5**

Secure clip to the Fixing Plate.

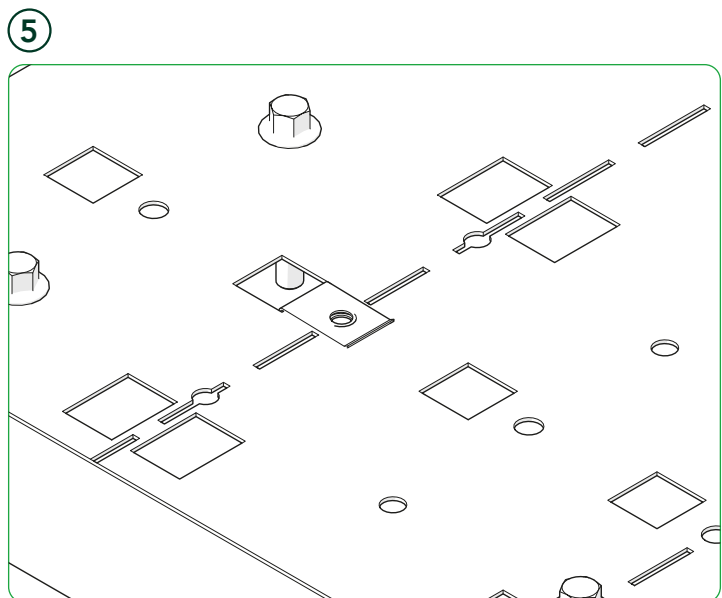
**STEP 6**

Screw on the threaded rod to the clip.

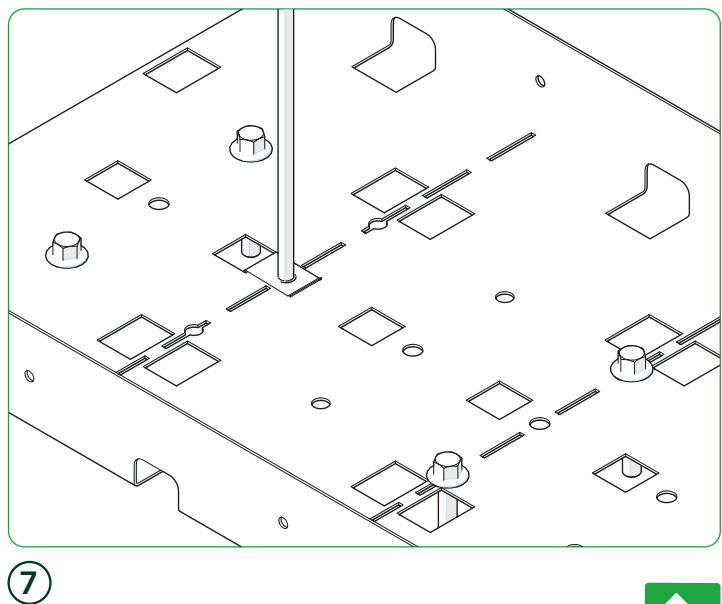
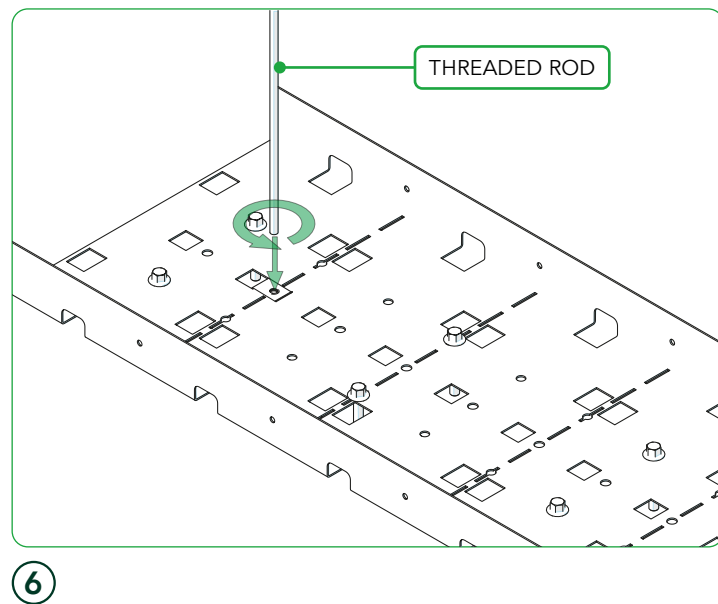

STEP 8

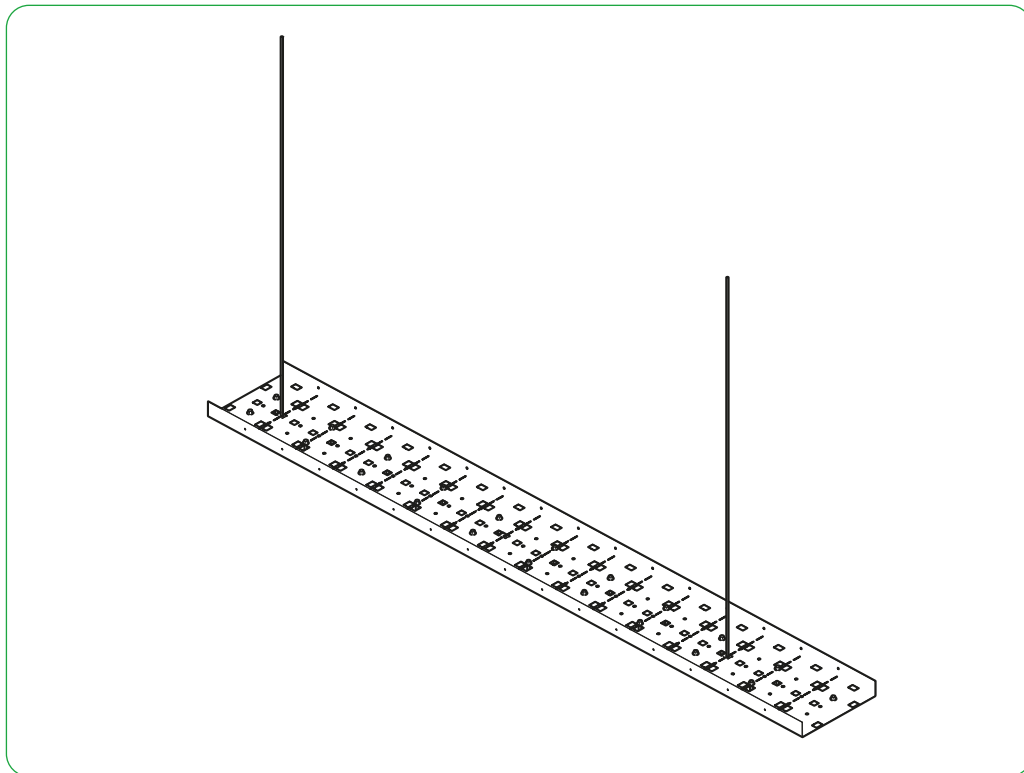

We recommend using a minimum of 2 connection points per length of fixing plate, this will give sufficient tension to the wall once completed.

STEP 9

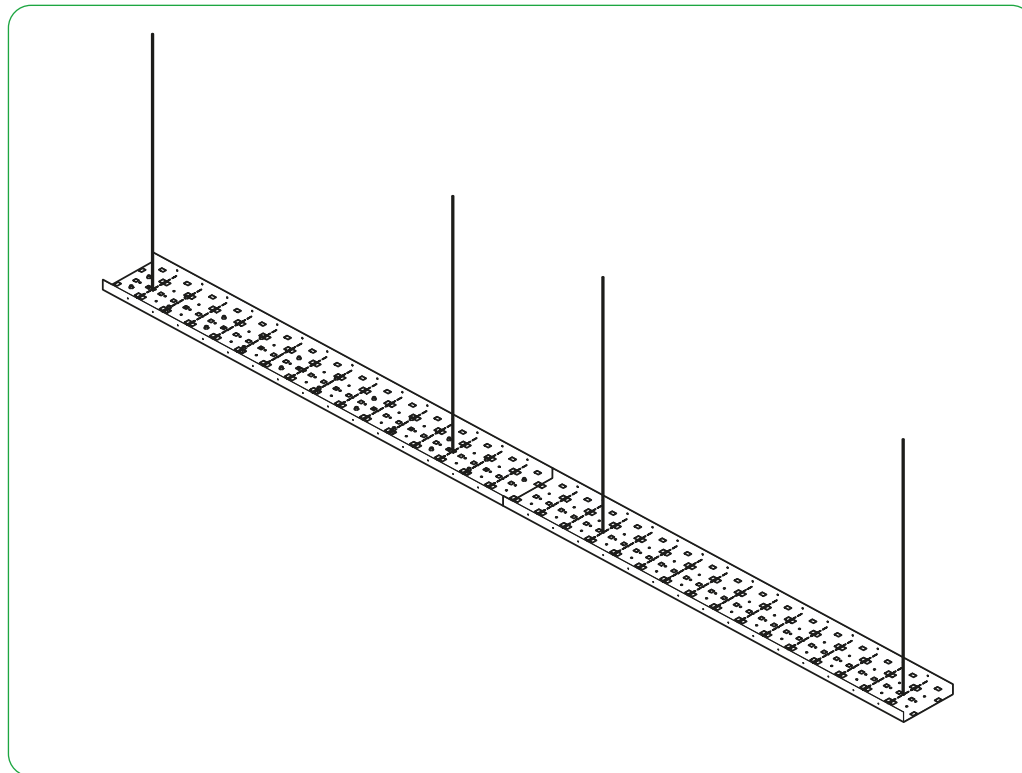

Lengths of fixing plate easily join together to increase the size of your structure.



STEP 10

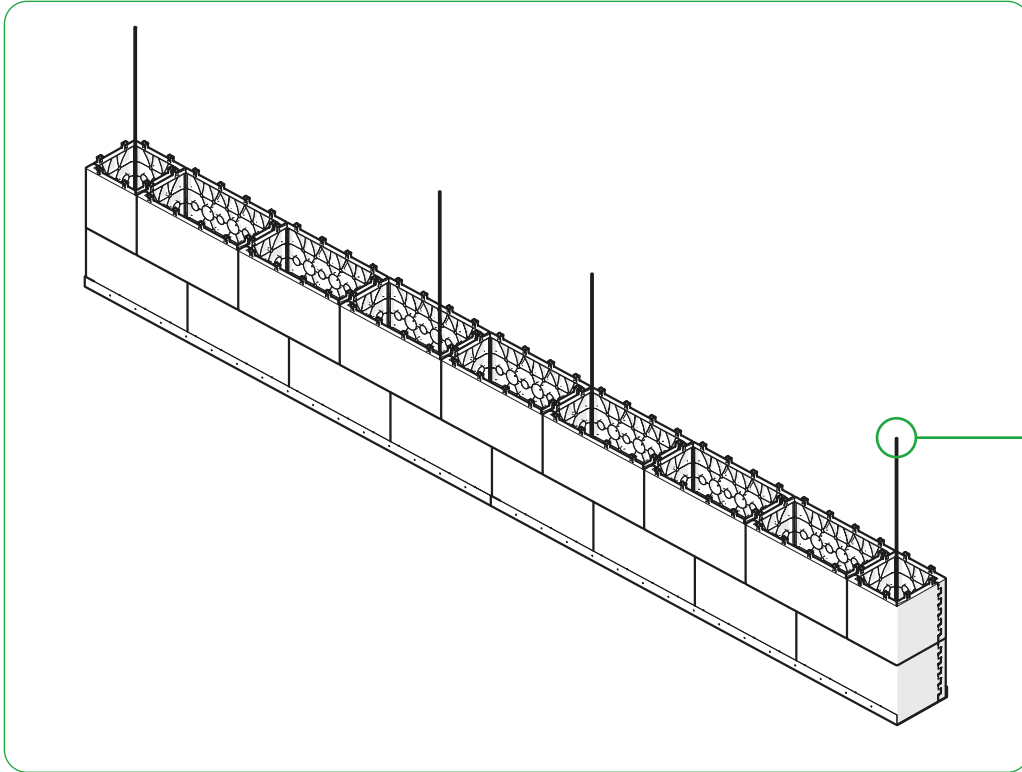

Once the first length of threaded rod has been attached to the fixing plates, construct the first two layers of blocks.

STEP 11

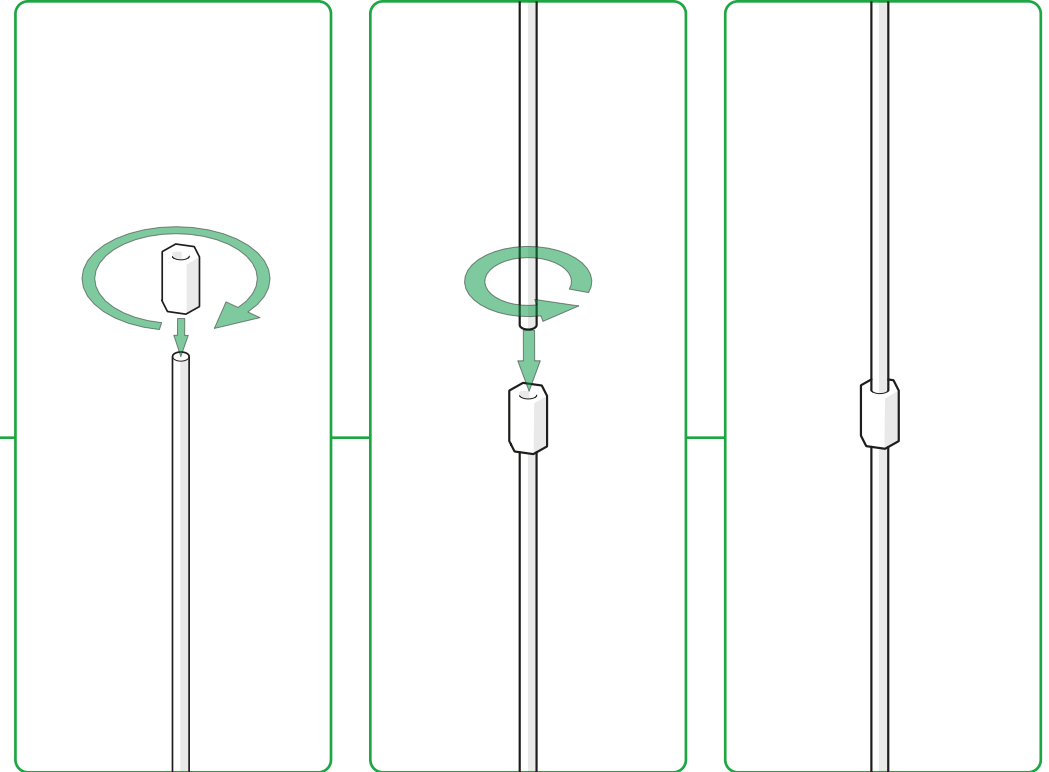

Using the threaded rod connectors, you can increase the length of the rod.



STEP 12

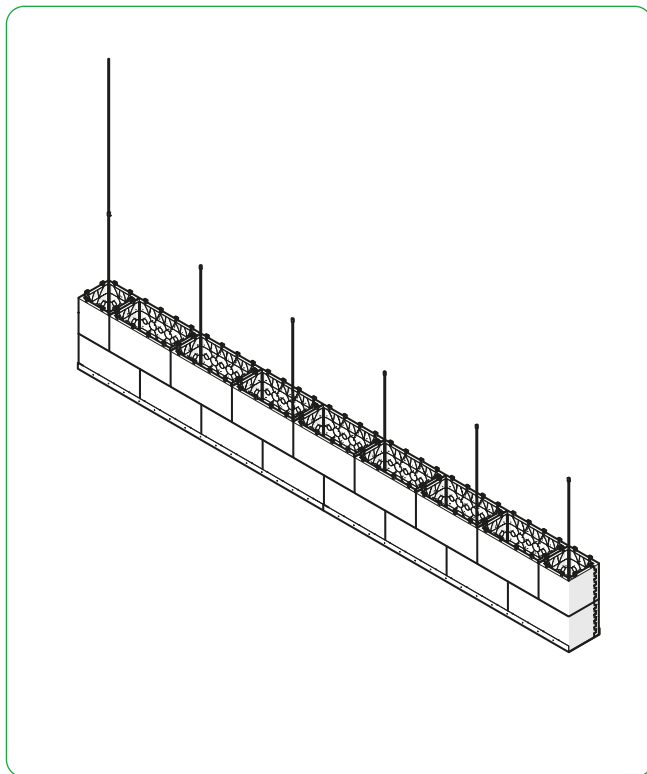

Repeat step 11 across all sections of the threaded rod.

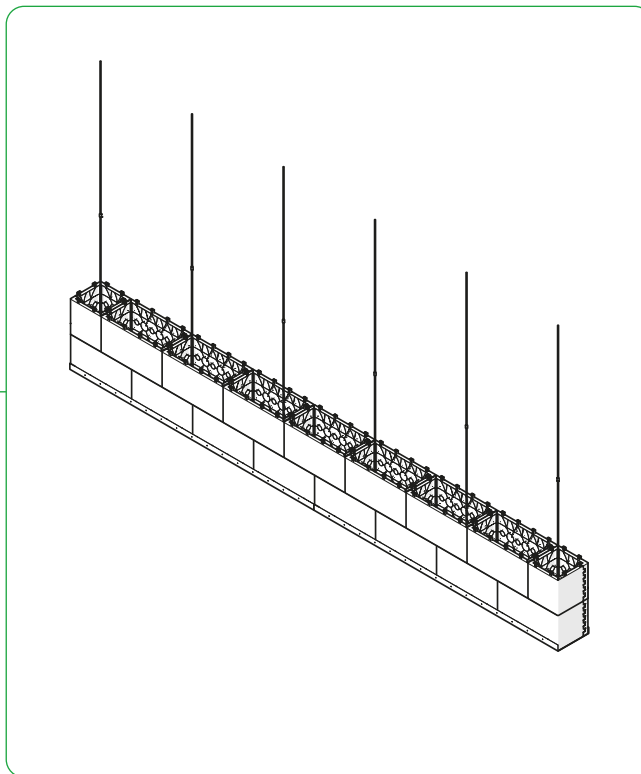

STEP 13

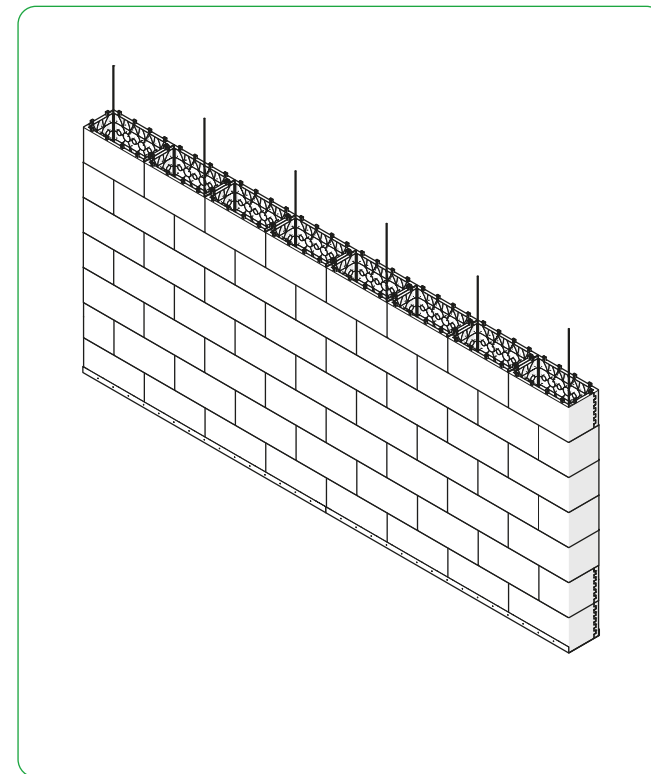

Build up the structure around the threaded rod.



STEP 14

Use another fixing plate, rotated so it is facing down*, on top of the wall. Make sure to align the holes in the tracking with the threaded rod.

*EXAMPLE OF ROTATED FIXING PLATE

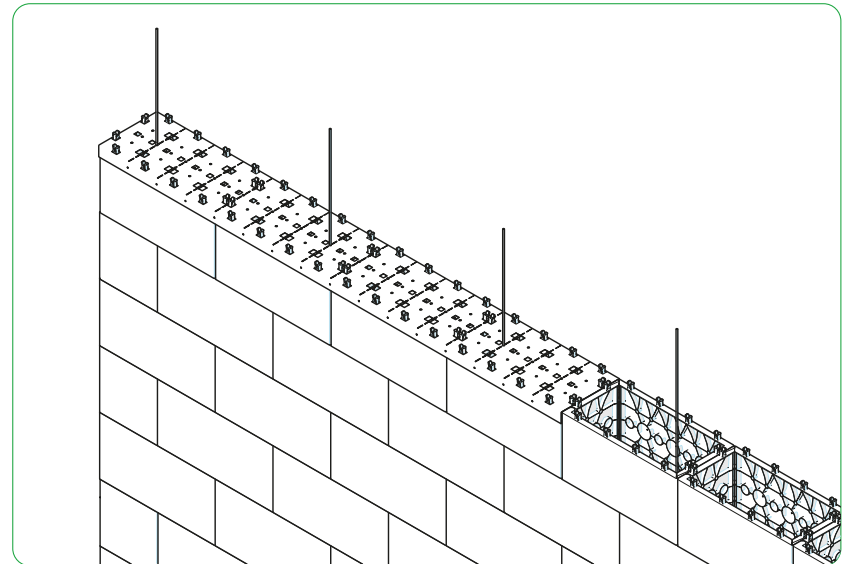
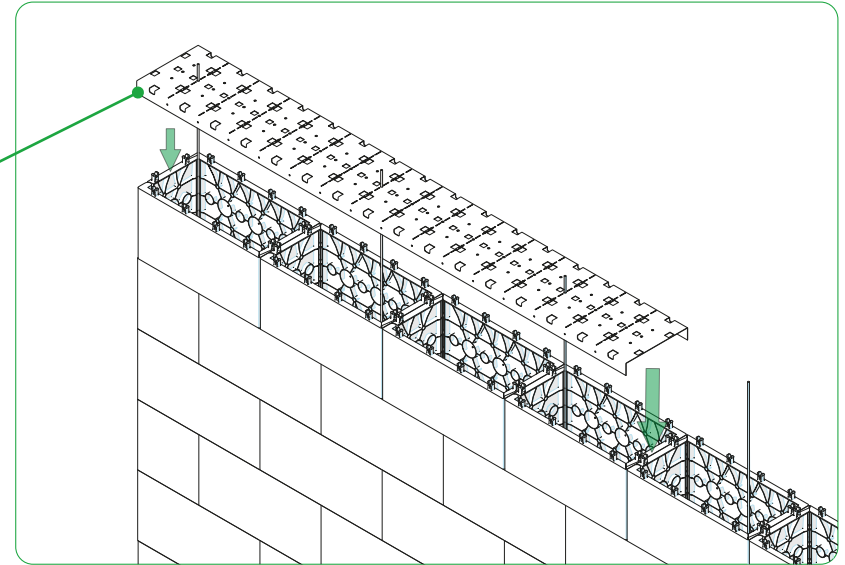
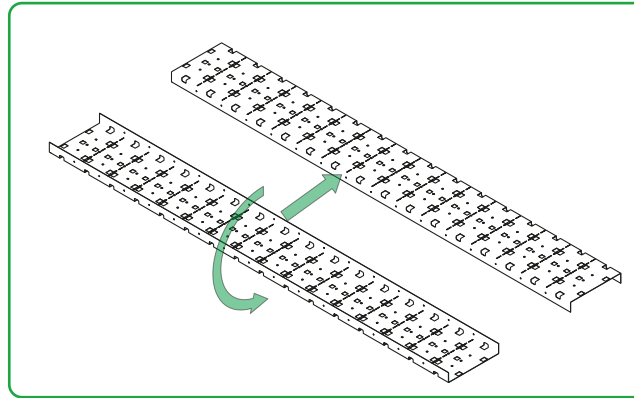

STEP 15

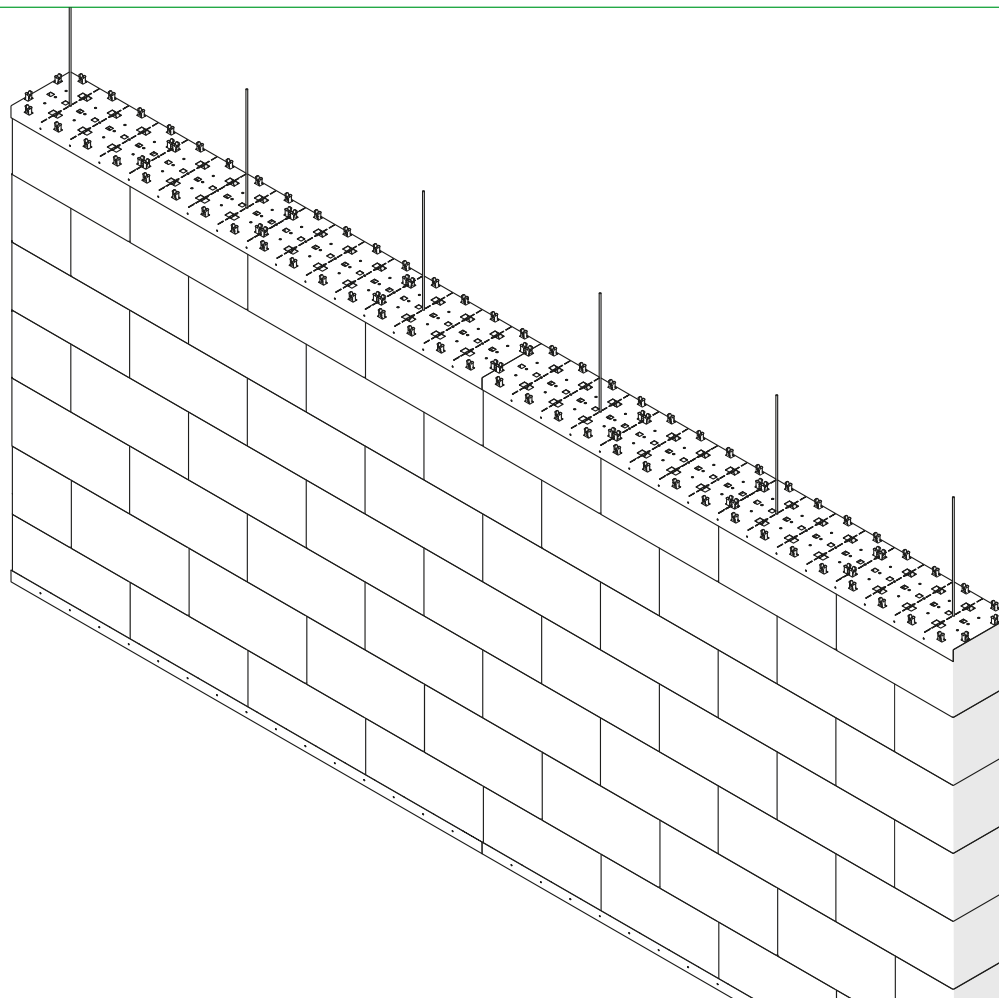

Repeat step 14 where required across the top of the wall.



STEP 16

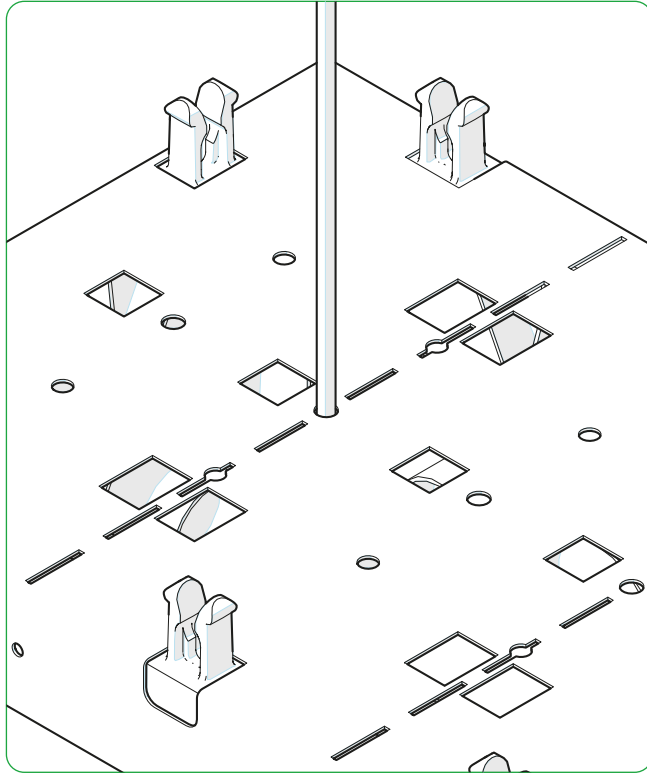

Using the washers and flange nuts supplied, secure on to the threaded rod.

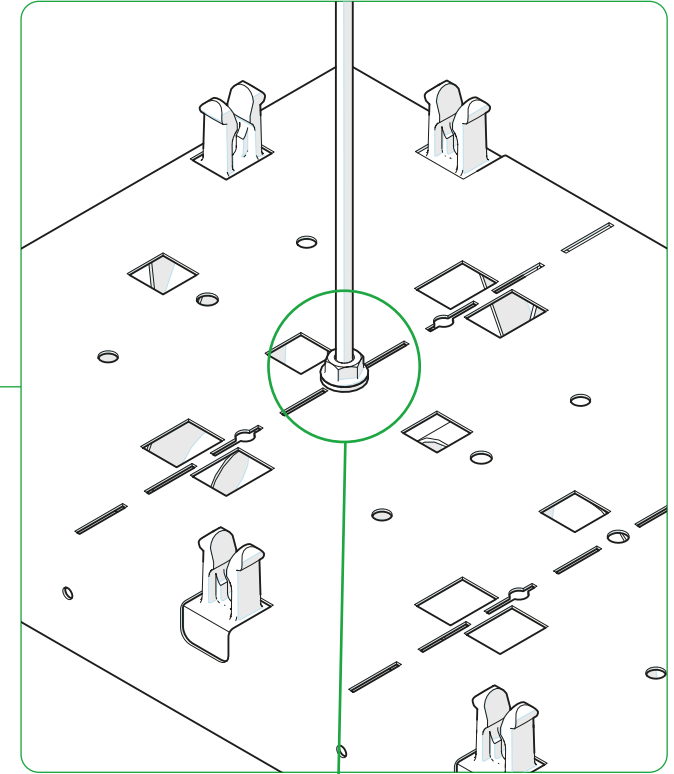
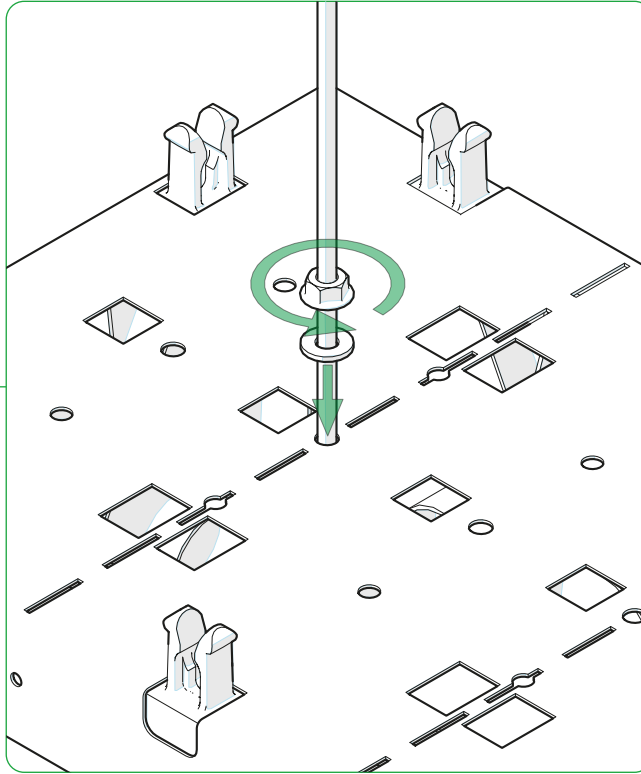

Do not over-tighten.
Trim threaded rod once secured,
this can be done with bolt
cutters or an angle grinder.

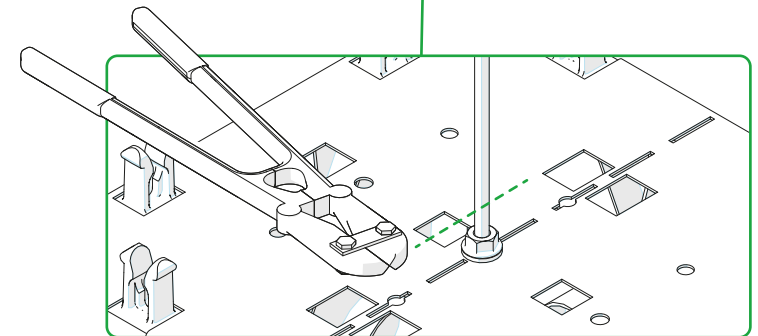

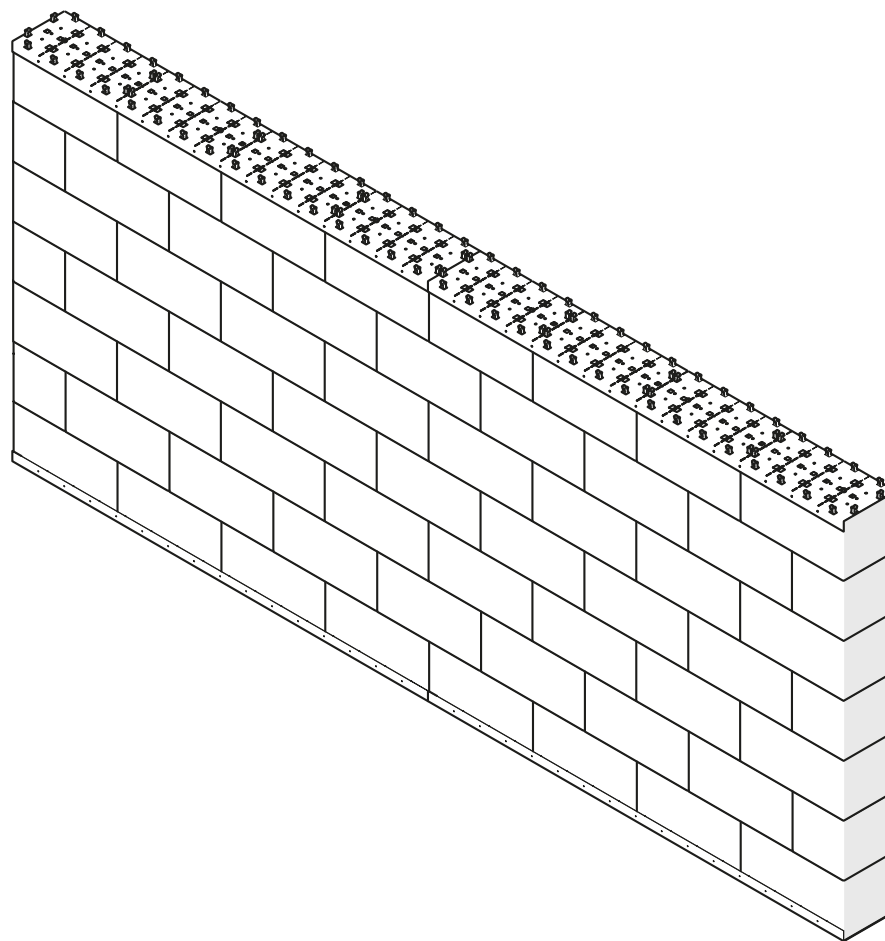

Completed straight section of QUICKBLOCK wall with fixing plates.



